

Fire detection and evacuation solutions that save lives.

Anti-Ligature Detector Mounting

Features

- Anti-Ligature Detection - suitable for secure accommodation
- Multiple Mounting Options - can be ceiling or wall mounted
- Ease of Installation - Xpert card simplifies addressing
- In-Built Isolation - built in isolator
- Various Detector Types - can be used with various Ampac detectors
- 'Lip and Ridge' Arrangement - prevents concealment of prohibited items

Description

Designed predominantly for use in areas where care of at risk persons is provided, the device provides anti-ligature protection to ensure the safety of occupants.

The unit has been designed to accept a XP95/Discovery mounting base together with a standard Ampac multicriteria detector. It can be either ceiling mounted or wall mounted using an angled mounting box.

To simplify and speed up installation and commissioning, the device address is set by simply removing 'pips' on a card. The coded XPERT card is then inserted into the side of the base where it locks into position.

Utilising built in isolation, the unit can be used with the full range of Ampac addressable fire alarm systems.



Specifications

Dimensions

Wall Mounted Box	131mm H x 183mm W x 90mm D
Ceiling Mounted Box	130mm H x 130mm W x 36mm D

Anti-Ligature Breaking Weight

*Weights before Anti-Ligature detector breaks and reports 'Missing' at the Indicator

Ceiling Mounted Box (Pulling at an angle of 0 degrees)	7.09kg
Wall Mounted Box (Pulling at an angle of 45 degrees)	3.97kg

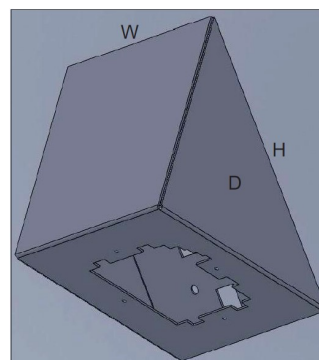

Wall Mount Box

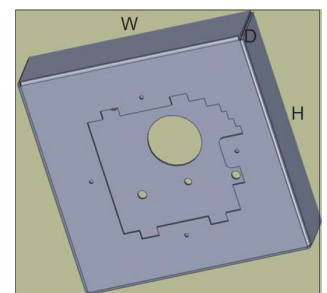

Ceiling Mount Box

Item Numbers

Panels

4112-2010	Ceiling Box (For 4112-2011)
4112-2011	Base Assembly for XP95/Discovery
4112-2012	Angled Wall Box (For 4112-2011)