



## Intelligent Manual Call Point Installation Guide

Item No	Part No	Product Name	Type
4105-2005	SA5900-908AMP	Intelligent Manual Call Point	Indoor

### Technical Information



100µA (24V supply voltage)



17-35V DC



4.0mA (24V supply voltage)



-40°C to 70°C



IP44

### Product Overview

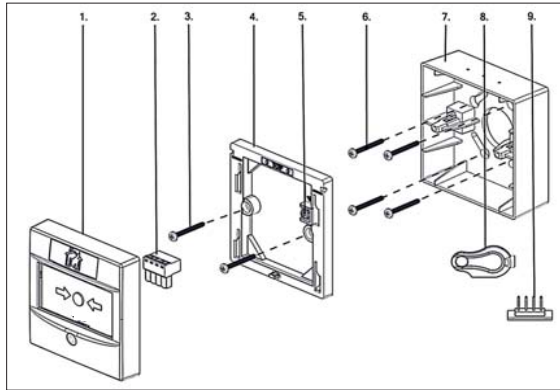

Item	Qty.	Item	Qty.
1. Head unit	1	6. Fixing screws (NOT SUPPLIED)	N/A
2. Connector block	1	7. Backbox	1
3. Fixing screws	2	8. Reset key	1
4. Mounting bracket	1	9. Continuity link	1
5. Earth Continuity Terminal	1		

## Installation

**1**

**2**

**0.6Nm**

**3**

**4**

**5**

**6**

**7**

**53**  
1 0 1 0 1 1 0 0

ON

1 2 3 4 5 6 7 8

**⚠** The 8th segment must be in set to "0" for Discovery or XP95 operation

**8**

**⚠** Do not overtighten screws

**0.6Nm**

**9**

**10**

**11**

Note the alignment marks

**12**

## Address Setting Examples

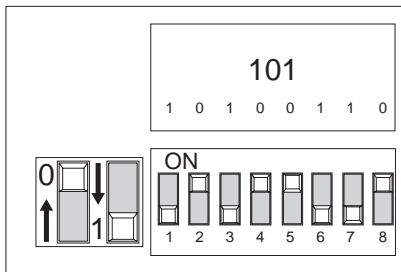
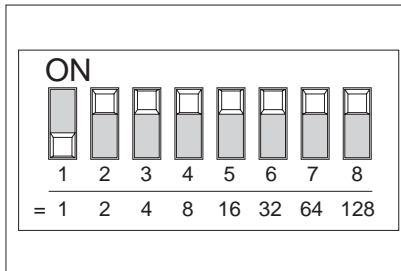

## Removal

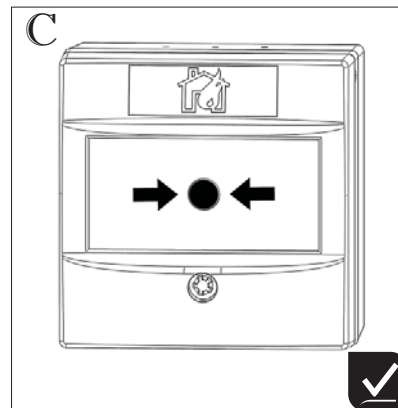
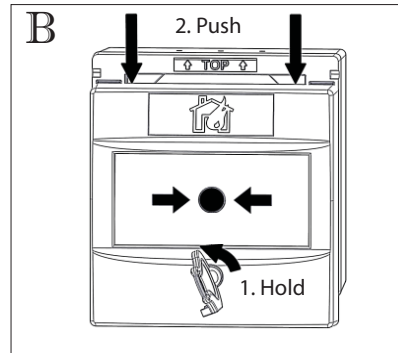
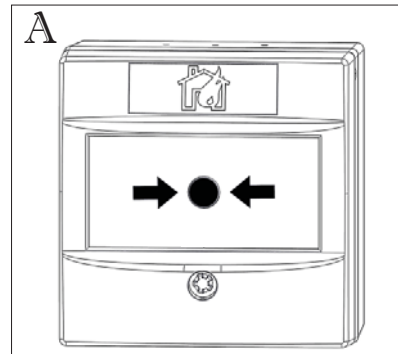

## Testing

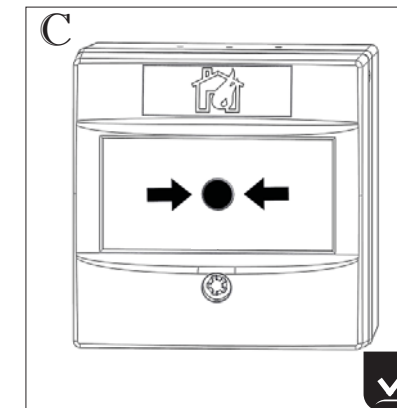
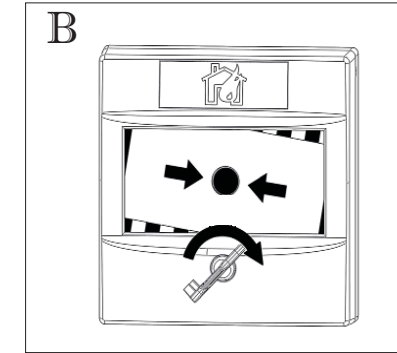
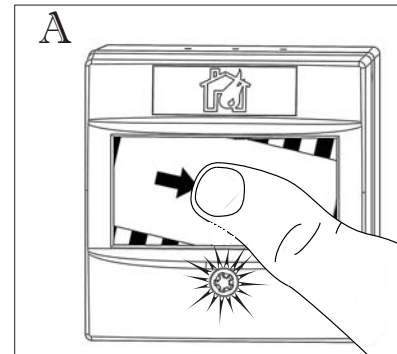

### LED Indicator

Illuminated red (under CIE control) when call point is operated.  
Illuminated yellow when short-circuit isolator has operated (version with integrated isolator). Flashing yellow when a fault has occurred.  
Flashing green when MCP is polled by the control panel (Discovery only).

### Commissioning

The installation must conform to applicable local codes.

### Transparent Hinged Cover

To provide additional protection against accidental operation, a Transparent Hinged Cover, item number 4105-2003 (part no 44251-189) is available.

### Troubleshooting

Before investigating individual units for faults, it is important to check that the system wiring is fault free. Earth faults on data loops or interface zone wiring may cause communication errors. Many fault conditions are the result of simple wiring errors. Check all connections to the unit.

For additional technical information please refer to the following documents which are available on request.

PDS4105-2005 - Intelligent Manual Call Point Data Sheet  
PDS201-9001 - Short Circuit Isolator Data Sheet

Ampac

7 Ledger Road, Balcatta, Western Australia 6021  
Telephone: +618 9201 6100 Fax: +618 9201 6101  
email: info@ampac.net Website: www.ampac.net