

SmartGraphics^{HD} – A FireFinder Compatible Product

Features

- Provides a graphical interface to the FireFinder fire detection and EV3000 Emergency Warning and Intercom System
- Shows the seat and spread of the fire
- Displays the spread of smoke by monitoring the air handling units
- Allows rapid response to the fire event by emergency services
- Tracks the building evacuation procedure
- Reduces maintenance costs for multi-site complexes by allowing monitoring from a single point
- Allows post-mortem of the fire event
- Building information database
- Contact information database
- Restricted access for control and maintenance functions

Description

The Ampac **SmartGraphics^{HD}** system unleashes the full power of **FireFinder** and the **EV3000** by creating a robust and versatile hub for monitoring, maintaining and controlling your fire detection, alarm and intercom systems with one fully integrated package.

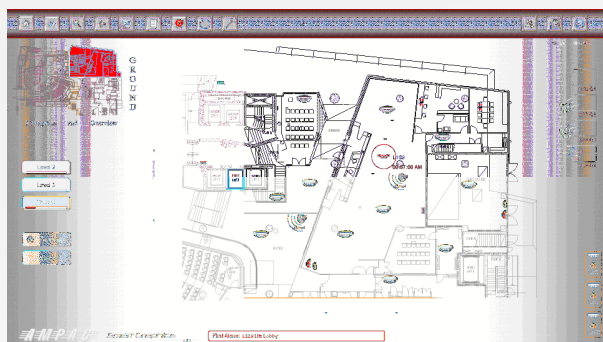

In a fire event, the seat of the fire is uniquely identified and time stamped and subsequent fire alarms are time stamped, allowing the operator to see where the fire has started and where and how quickly it is spreading. In addition the status the air handling units, smoke spill and stair pressurisation fans can be monitored to show the spread of smoke.

The Ampac **SmartGraphics^{HD}** system can generate floor maps which show the seat and spread of the fire and an access map showing the preferred route to the fire event. These maps can be e-mailed to the emergency dispatch centre, and then forwarded to emergency response personnel whilst they are on route to the fire event



SmartGraphics^{HD} Touch Screen

As **SmartGraphics^{HD}** can be connected to multiple sites using existing IT infrastructure, it is possible to monitor multiple sites from one central location. This coupled with **SmartGraphics^{HD}** extensive logging capabilities allows the monitoring and maintenance of the fire detection, alarm and intercom systems to be managed from one location. The logging allows a post mortem of any fire event or other emergency condition.

The Ampac **SmartGraphics^{HD}** system includes a dedicated database for holding building information, like hazardous material stores with each entry hyperlinked to a floor map. Other fittings, like fire extinguishers, hose reels etc can also be included on floor maps. A dedicated database for key building personnel is available.

SmartGraphics^{HD} supports the latest high definition display format of 1920 x 1080 with touch screens. Displays can be wall or desk mounted.

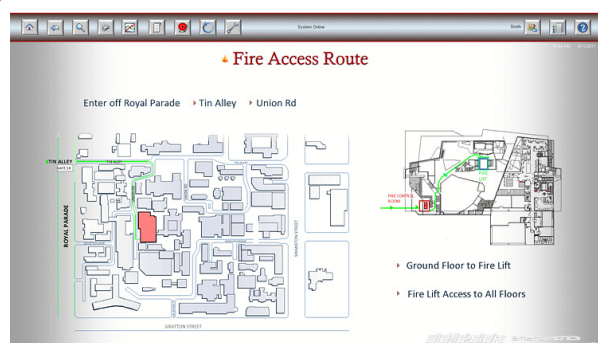

SmartGraphics^{HD} – A FireFinder Compatible Product

Item Numbers

4100-0002	License package only
4100-0003	Licence package and computer – including a colour laser printer
4100-0004	Licence package and embedded computer with touch screen – including a colour laser printer
4100-0005	Licence package and computer with touch screen monitor – including a colour laser printer
4100-0006	USB-RS232 Converter Kit
4100-0007	USB-RS485/422 Converter Kit

Specifications

Computer (Minimum Requirements)	Intel Core i7 Processor, 8GB RAM, 500 GB Hard drive, CDROM and USB ports for communications for fire alarm system using RS232 or RS485.
Operating System	Windows 8 Professional (64bit)
Monitor	Resolution 1920 x 1080
Dimensions (cm)	
Monitor only	58 W x 39 H x 6 D
Including Base	58 W x 45 H x 20 D
RS232 Comms	1 pair twisted & screened 15m maximum from FireFinder Baud rate – 9600 to 38400
RS485 Comms	1 pair twisted & screened 1200m maximum from FireFinder Baud rate – 9600 to 38400

